

SHAFT SIZE, According to layout of entrances, car dimensions, type of drive, optional self supporting structure
 (See figures 1,2,3).

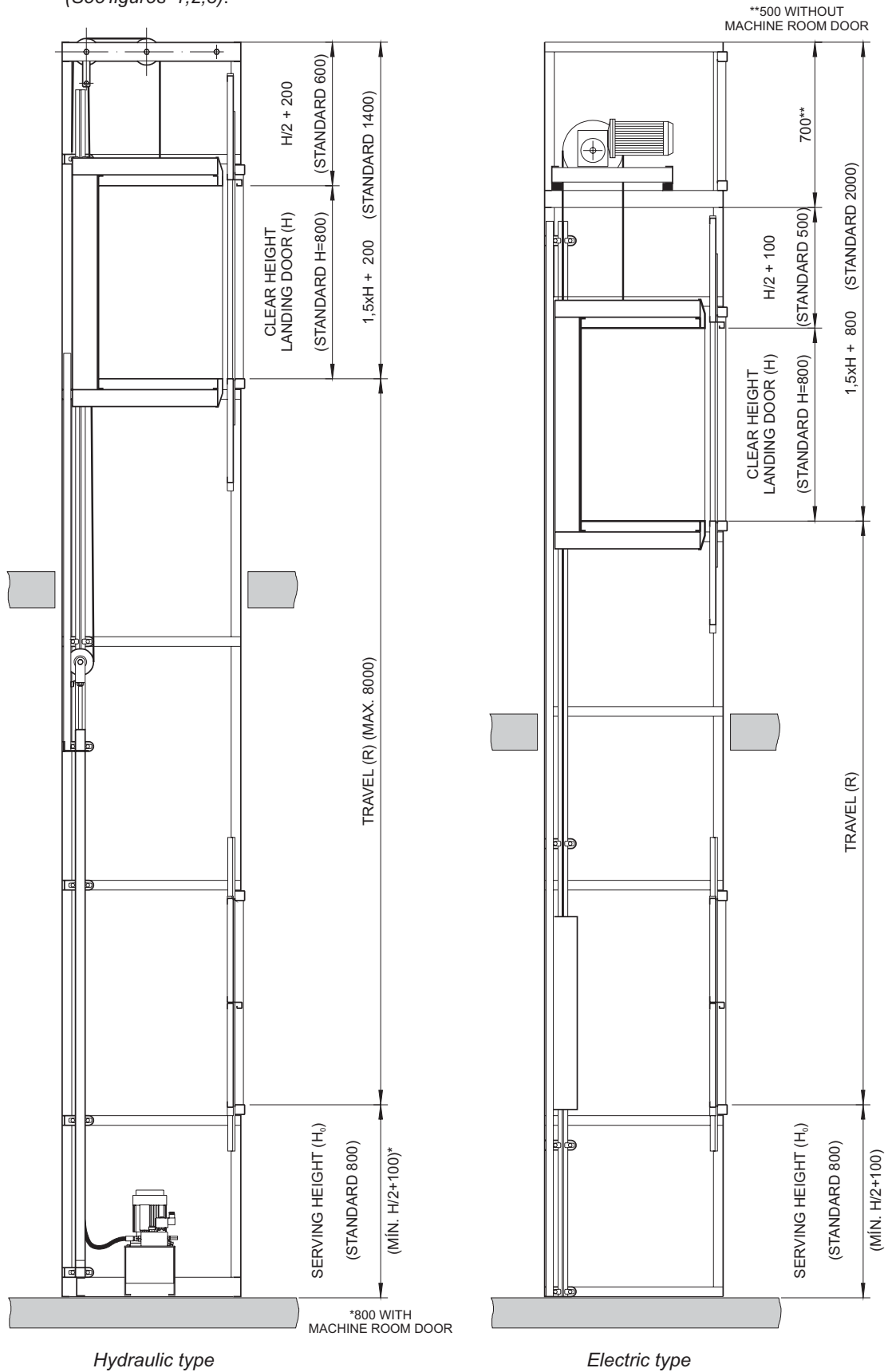
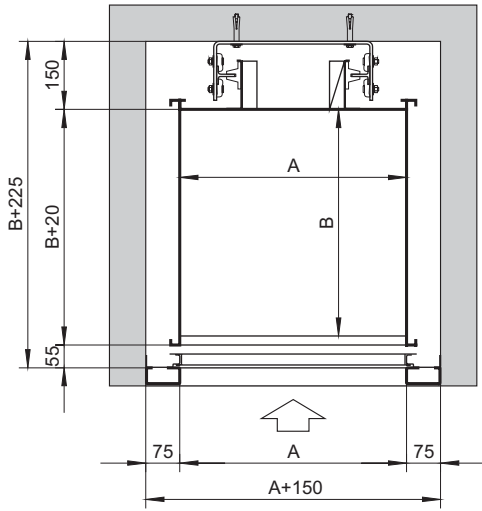

Figure 1. Minimum shaft size (side view).



Layout 1

Figure 2. Minimum shaft size (plan)
 Without structure:Fastening on wall..

Layouts	Car Dimensions	Clear Car Dimensions	Minimum Shaft Size
1		A B+20	
2,3		A+20 B	
4,5	A B	A+20 B+20	A+150 B+225
6		A+40 B	
7		A+20 B+20	

1. In case of car doors, B-100
2. In case of car doors, B-200

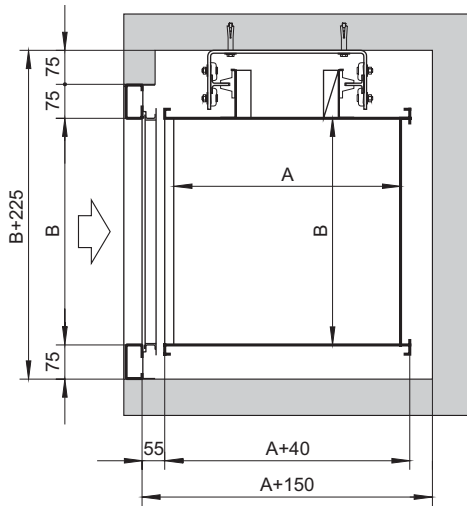

Layout 2-3

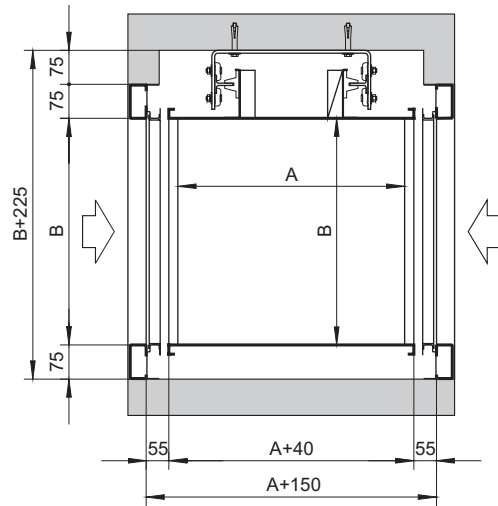

Layout 6

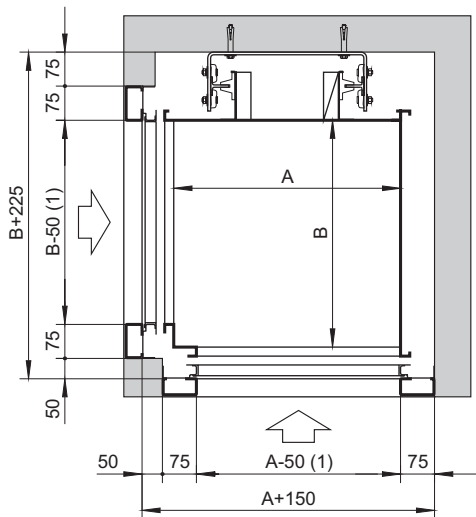

Layout 4-5

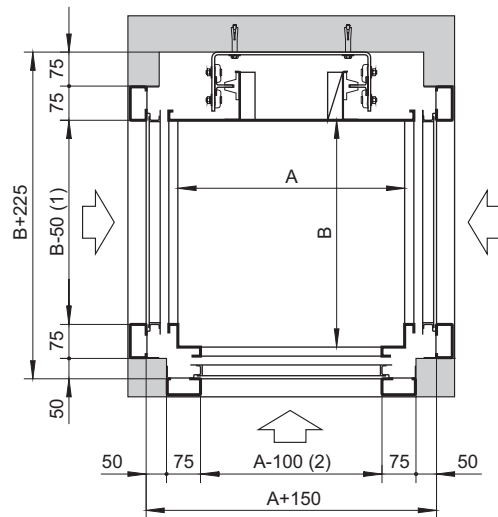

Layout 7

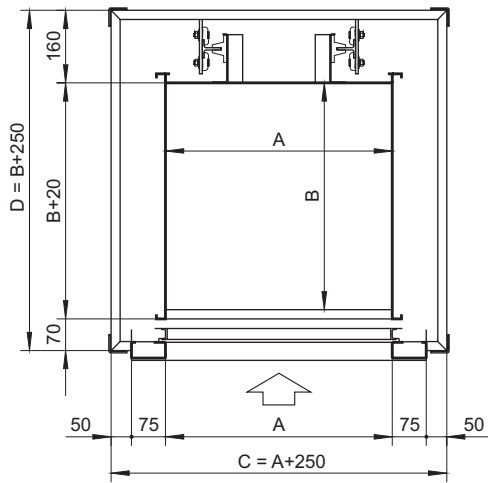

Layout 1

Figure 3. Minimum shaft size (Plan).
 With self-supporting structure.

Layouts	Car Dimensions	Clear Car Dimensions	Minimum Size of Shaft (C+30)x(D+30)
1		A B+20	A+280 B+280
2,3		A+20 B	A+210 B+310
4,5	A B	A+20 B+20	A+240 B+280
6		A+40 B	A+210 B+310
7		A+20 B+20	A+210 B+280

1. In case of car doors, B-100
2. In case of car doors, B-200

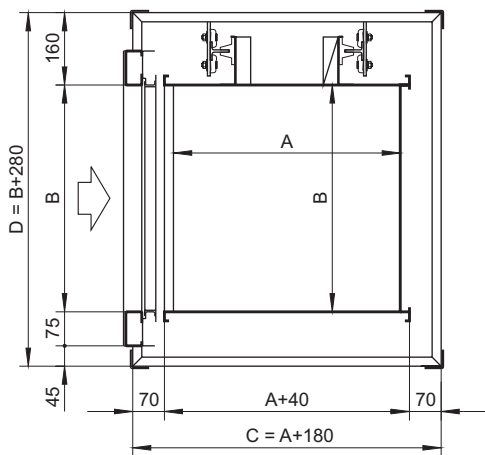

Layouts 2-3

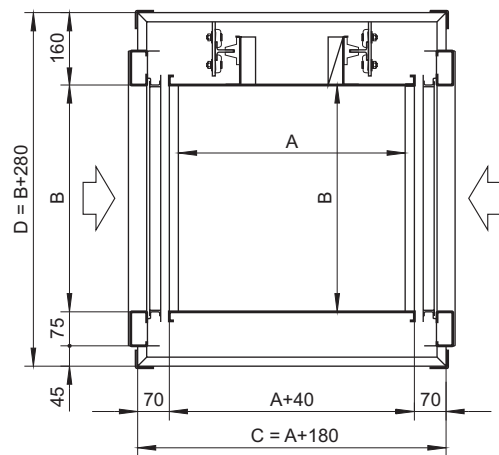

Layouts 6

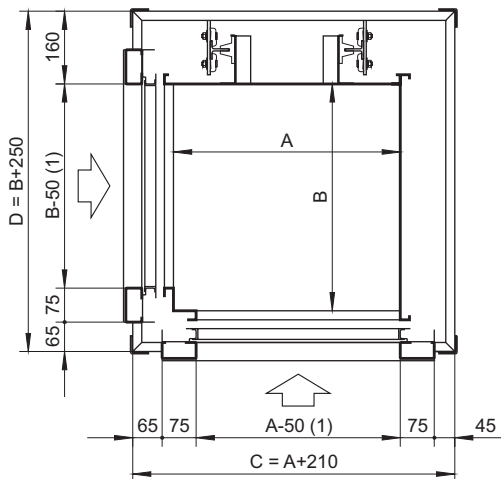

Layouts 4-5

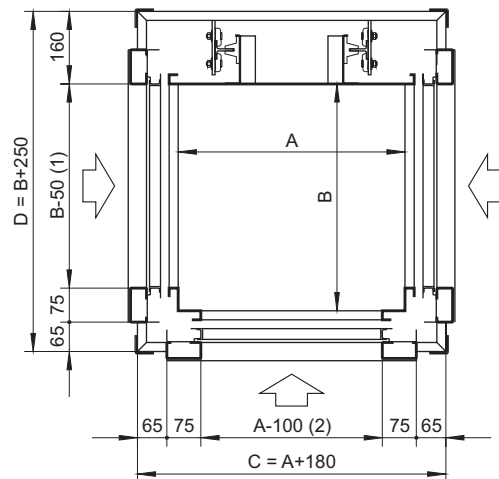

Layouts 7